



Humming Retreat

— Enriching Lives Affordably —

Get ready to live your dream...



UPRERA Registration No.: UPRERAPRJ17775 (Phase-1)
UPRERAPRJ17781 (Phase-2)

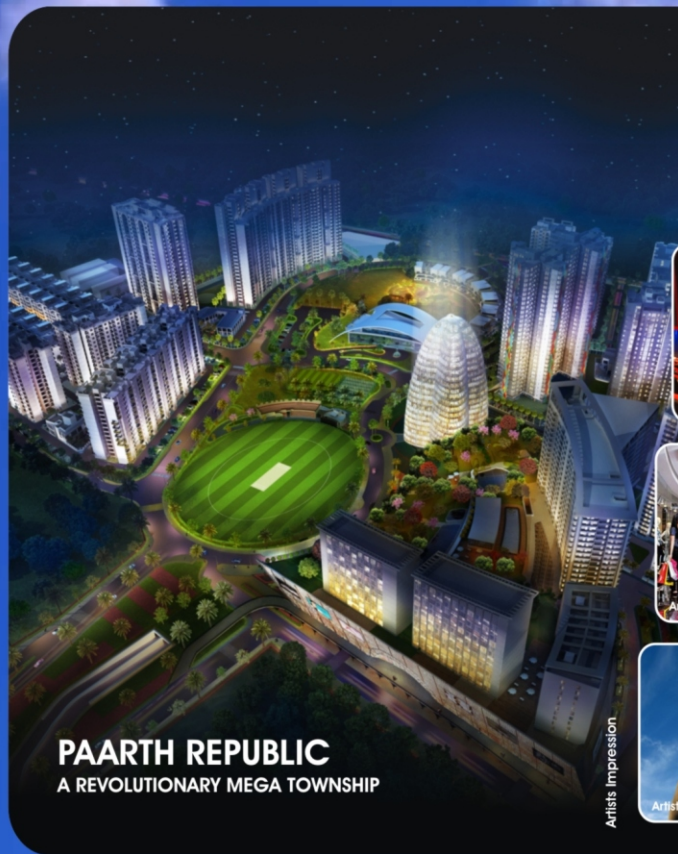

PAARTH REPUBLIC

A REVOLUTIONARY MEGA TOWNSHIP

Artists Impression



Actual Image



Artists Impression



Artists Impression



Artists Impression



Smart Living for A Smart Generation

- Intelligent Traffic Management System
- Optical Fibre Cable in Entire Township
- Water Harvesting & Self sustained Natural Living
- Wi-Fi Enabled Zone
- Intelligent Physical Infrastructure
- Gated Security
- Multi Screen Multiplex
- Branded Apartment & State-of-the-art-office
- Innovative Mix- Land use
- Biggest Mall with National/International Brands
- Open to Sky Cafeteria
- Paarth Centre for Excellence in Cricket (PCEC)
- Landscaped Green for visual retreat



Enriching Lives Affordably

Humming Retreat, part of Paarth Republic Revolutionary Mega Township, offers smartly designed apartments, bringing together good living spaces, surrounded by the best facilities within the township, enabling a healthy, active and purposeful life to affordable segment. These apartments come in 2 convenient options of 1BHK (525 sqft) and 2 BHK (805sqft).

Humming Retreat enjoys easy, quick and congestion-free access on Lucknow-Kanpur Highway, near Airport and metro head. Find your own space at just the right place and get ready to move into your new apartment!





UNIT PLAN



1 BHK UNIT PLAN
Tower 2

Accommodation:

1 Bedroom, Living/Dining,
Kitchen, 1 Toilet, 2 Balconies

Carpet Area : 294.50 sq.ft. (27.37 sq.mt.)

Balcony Area : 38.96 sq.ft. (3.62 sq.mft.)

Built-Up Area : 386.32 sq.ft. (35.89 sq.mt.)

Super Area : 525.00 sq.ft. (48.77 sq.mt.)



2 BHK UNIT PLAN
Tower 1 & 2

Accommodation:

2 Bedroom, Living/Dining,
Kitchen, 1 Toilet, 2 Balconies

Carpet Area : 468.81 sq.ft. (43.57 sq.mt.)

Balcony Area : 52.64 sq.ft. (4.89 sq.mt.)

Built-Up Area : 591.91 sq.ft. (54.99 sq.mt.)

Super Area : 805.00 sq.ft. (74.79 sq.mt.)

1 sq.mt. = 10.764 sq.ft.





FLOOR PLAN

Typical Floor Plan Ground to 14th Floor

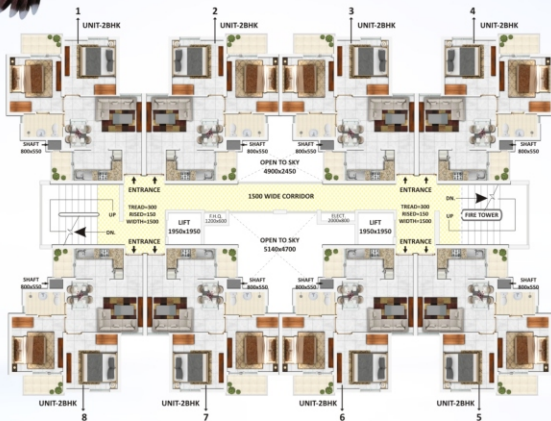

Tower - 1

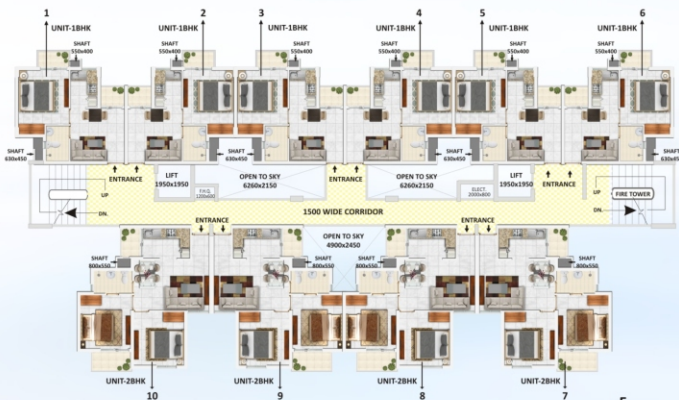

Tower - 2



Disclaimer: In Tower No. 1 Unit No. 3 & in Tower No. 2 Unit No. 8 does not exist at Ground Floor.

SPECIFICATIONS



| Particulars | | | 5th to 13th floor | Ground to 4th Floor and 14th floor | |
|-----------------------|-------------------|---|-----------------------------------|------------------------------------|--|
| Room | TYPE | FINISH | AFFORDABLE | PREMIUM | MAKE * |
| LIVING/DINING | FLOOR | Vitrified Tiles | Basic range | Standard / Commercial range | Kajaria / RAK / Somany / Asian / Lexus or equivalent |
| | WALL | Acrylic O.B.D | Basic Range | Standard range | Asian / Nerolac / Berger / Dulux or equivalent |
| | CEILING | White Acrylic O.B.D | Basic Range | Standard range | Asian / Nerolac / Berger / Dulux or equivalent |
| | AIR CONDITIONING | Provision for Air Conditioning | Conduit | Wiring & Piping | |
| BED ROOM | FLOOR | Vitrified Tiles | Basic range | Standard / Commercial range | Kajaria / RAK / Somany / Asian / Lexus or equivalent |
| | WALL | Acrylic O.B.D | Basic range | Standard range | Asian / Nerolac / Berger / Dulux or equivalent |
| | CEILING | White Acrylic O.B.D | Basic range | Standard range | Asian / Nerolac / Berger / Dulux or equivalent |
| | AIR CONDITIONING | Provision for Air Conditioning | Conduit | Wiring & Piping | |
| KITCHEN | FLOOR | Vitrified Tiles | Basic range | Standard / Commercial range | Kajaria / RAK / Somany / Asian / Lexus or equivalent |
| | WALLS | Ceramic Tiles Dado upto 2' above counter, O.B.D | Commercial range | Standard / Commercial range | Asian / Nerolac / Berger / Dulux or equivalent |
| | CEILING | White Acrylic O.B.D | Basic Range | Standard range | Asian / Nerolac / Berger / Dulux or equivalent |
| | COUNTER Finish | Graite/ Kota/Marble | Kota/Marble | Granite | |
| | CP FITTINGS | C.P Fittings, Single Bowl S.S Sink | Basic Range | Standard range | Nirali / Lotus or equivalent |
| TOILET | FLOOR | Anti-skid Ceramic Tiles | Basic range | Standard range | Kajaria / RAK / Somany / Asian / Lexus or equivalent |
| | WALLS | Ceramic Tiles Dado upto 7' above counter, O.B.D | Commercial range | Standard range | Asian / Nerolac / Berger or equivalent |
| | CEILING | O.B.D | Basic Range | Standard range | Asian / Nerolac / Berger or equivalent |
| | CP FITTINGS | Single lever diverted Fittings | Basic Range (Conventional System) | Standard / Commercial range | Jaquar / Hindware or equivalent |
| | SANITARY FITTINGS | Floor Mounted Water Closets | Basic Range (Conventional System) | Standard / Commercial range | Hindware / CERA or equivalent |
| BALCONY | FLOOR | Anti Skid Ceramic Tiles | Basic range | Standard / Commercial range | Kajaria / RAK or equivalent |
| | WALL | Exterior Weather Shield Paint | Basic Range | Standard range | Asian / Nerolac / Berger or equivalent |
| | CEILING | Exterior Weather Shield Paint over plaster | Basic Range | Standard range | Asian / Nerolac / Berger or equivalent |
| | RAILING | M.S Railing | Standard Range | Standard range | |
| DOORS | MAIN DOOR | Skin Moulded with brass fittings & mortice lock | Basic Range | Standard range | Skin Moulded |
| | INTERNAL DOORS | Skin Moulded with steel fittings & mortice lock | Basic Range | Standard range | |
| | BALCONY DOORS | Aluminium Frame with Clear Glass | Basic Range | Standard range | |
| WINDOWS | | Aluminium Frame with Clear Glass | Basic Range | Standard range | |
| ELECTRIC WORK | | Copper wire, Modular switches, Sockets | Basic Range | Standard range | |
| STAIRS & COMMON AREAS | | M.S Railing, Marble/Granite/Kota | Marble/Kota/Tile | Granite | |
| EXTERIOR PAINT | | Exterior Weather Shield Paint | Standard range | Standard range | Asian / Nerolac / Berger/Unitle/Acro or equivalent |

* Make is for premium category only.

Actual Construction Images



Goldfinch



Humming State



Asha-Abha



Gardenia



Canary

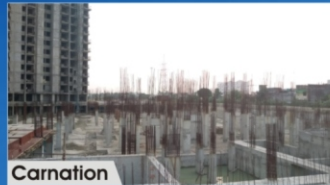

Carnation

Actual Pictures of Township



Entrance Gate



Kids Play Area



Cricket Stadium

Location Map



not to scale

Call: 7505586655, Toll Free No.: 1800 102 5914



Regional Office: 3rd Floor, Eldeco Corporate Tower, Vibhuti Khand, Gomti Nagar, Lucknow-226010, Phone: 0522-4500500
Site Office: Paarth Republic, Miranpur Pinwat, Lucknow-Kanpur Road, Lucknow-226401, U.P. (Open All 7 Days)
Registered Office: Paarth Infrabuild Pvt Ltd, Flat No. 311 to 315, Naurang House, 21 Kasturba Gandhi Marg, New Delhi-110001
Branch Office: 318-319 Kan Chambers 14/113, Civil Lines, Kanpur-228001 | **Corporate Office:** A-6, Sector-58, Noida, U.P. 201301
E-mail ID: sales@paarthinfra.com